

## DOTLINER 07.6

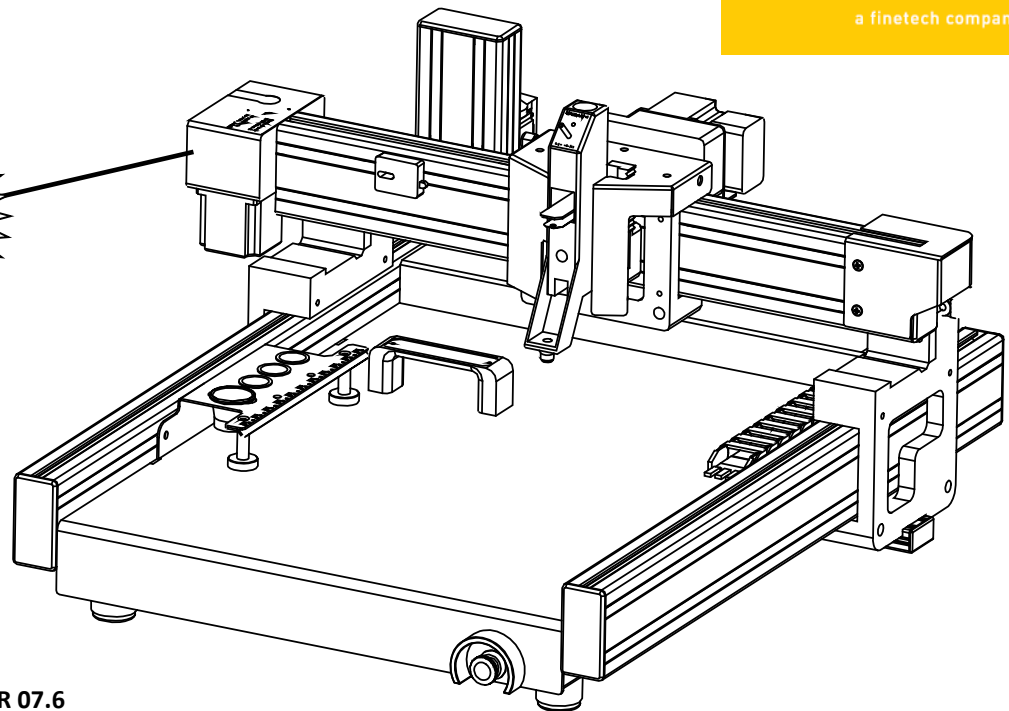

PD00.0071 DOTLINER 07.6

In DOTLINER dispensing robots the PCB is not moving but fixed in place. This eases loading and unloading of PCBs. MARTINs flexible PCB holders and PCB support tools allow the secure and stable installation of the substrates.

DOTLINER machines apply the well-proven ATP dispensing technology and are best prepared for micro dispensing applications. That involves dispensing of liquid materials like i.e. oil as well as high viscose products such as solder paste or grease.

A wide range of selections allow for instance heating of the dispense nozzle, cooling of cartridge, or the measuring of dispense height with touch-down sensor. All options can be used and configured through the newest version of PC software EASY DISPENSE Pro. A color CCD camera with Auto-Zoom function is available to measure-in the sample position.

MARTINs low stress dispense nozzles provide best material delivery conditions and are available with various nozzle diameter. Mechanical adapter take care to match even standard dispense needles with the heated MARTIN nozzle receptacle. The standard interface at DOTLINER dispense head enable quick change of the dispense heads.

### Standard Equipment

- Control unit with 5ccm dispensing head
- Motorized XYZ gantry system (stepper motor)
- Colour-zoom-camera
- 4x PCB magnet holders 40.5mm (standard)
- PCB support rail DL-type
- Test point and standby platform
- Manual

### Options

Vacuum Retract -20 mbar – 0 mbar (Fill Level Detection)

### Technical Data

Max. PCB size:	500 x 400 mm <sup>2</sup>
Travel:	495 x 325 mm
Travel-Speed:	1 – 9000 mm/min
Resolution of Axes:	0.013 mm
Dot Volume:	0.0005 – 5.0 mm <sup>3</sup>
Dot Diameter:	≥ 0,1 mm
Line Pressure:	0.1 – 5.0 bar
Syringe Heating:	20 - 50 °C
Temperature Compensation:	0 - 50 °C
Full level Compensation:	self learning
Mains:	230 VAC / 140 VA
Pressurized Air:	5.5 - 8 bar / water and oil free
Footprint:	700 x 600 mm <sup>2</sup>

Cartridge Heating elektr.: 90°C max.

# DOTLINER 07.6

## Optional Extras

PD50.0002 Starter Kit Dot Liner  
for solder paste applications



PD50.0003 Starter Kit Dot Liner  
for adhesive applications



HV00.0013 Cam Designer professional  
for Dot Liner, DVD, manual



CD00.0110 Auto vacuum module  
for thin fluids

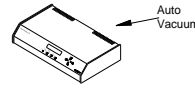

DK00.0062 Dispensing head 10ccm  
with heating, for CD06



10 ccm

DK00.0063 Dispensing head 30ccm  
with heating, for CD06



30 ccm

DK00.0064 Dispensing head 55ccm\*  
with heating, for CD06



55 ccm

DK00.0030 Hight sensor for dispensing head  
dispensing w/o spacer, incl. spacer "0.0"

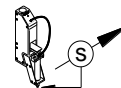

DK02.0002 Cooling Module 5ccm  
for DL / CD, 10 °C cooling power

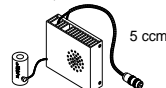

5 ccm

DK02.0003 Cooling Module 10ccm  
for DL / CD, 10 °C cooling power

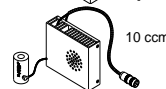

10 ccm

HT00.0002 Adhesive Volume Meter KVM-03  
measuring range 0.01-3,0 ccm

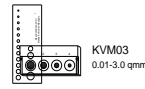

KVM03  
0.01-3.0 g/mm

HT00.8013 Metal Dispensing Nozzle 0.16 mm AH  
for paste 6, Pitch 0.4 - 0.8

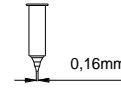

0,16mm

HT00.8010 Metal Dispensing Nozzle 0.2mm AH  
for paste 5, Pitch 0.5 - 1.0

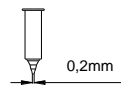

0,2mm

VD90.0039 Dispensing Needles/Nozzles set  
10 pieces each 18 types, box



HT00.9010 Spacer 0.10 mm  
for nozzle 0.2 mm

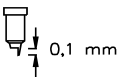

0,1 mm

HT00.9009 Spacer "0.0"  
for metal nozzles (from 0.16mm)

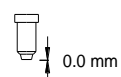

0,0 mm

HT00.9023 Spacer Pliers Lines Type A  
for needles 1.6 - 2.2mm, 1 ring

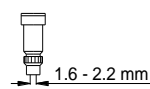

1.6 - 2.2 mm

HT00.8009 Micro Disp. Nozzle 0.17mm / 0.08  
for paste 6, pitch 0.4 - 0.8 mm

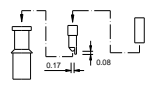

0,17 / 0,08

HT00.8004 Micro disp. nozzle 0.17mm / 0.0 HS  
for paste 6, pitch 0.4 - 0.8 mm

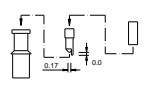

0,17 / 0,0

Further units and consumables under [www.martin-smt.de](http://www.martin-smt.de)